

Indexing Plungers

Steel / Stainless Steel, with Operating Lever, with External Thread

SPECIFICATION

Types

- Type **B**: Without rest position
- Type **C**: With rest position

Coding

- Coding **R**: Standard thread
- Coding **F**: Fine thread

Guide

- Steel **ST**
Zinc plated, blue passivated
- Stainless steel **AISI 303 NI**

Plunger pin

Stainless steel AISI 303

Lever

- Plastic, polyphthalamide (PPA)
- Glass fiber reinforced
 - Black **SW**

Pressure spring

Stainless steel AISI 302



INFORMATION

Indexing plungers GN 823 with operating lever can be used to lock carriages in guides, for example. The plunger pin is retracted by simply pressing the operating lever.

Type C also allows actuation by pulling and locking the plunger pin in the retracted position (rest position).

ACCESSORY

- GN 412.2 / GN 412.4 Positioning Bushings (with Collar) (see page 813)
- GN 412.3 / GN 412.5 Positioning Bushings (with Ramping Cone) (see page 812)
- GN 609.5 Distance Bushings (Stainless Steel) (see page 810)
- GN 412.1 Mounting Blocks (Zinc Die Casting) (see page 814)
- GN 612.1 Mounting Blocks (Steel) (see page 815)
- GN 909 / GN 909.5 Thin Hex Nuts (see page 809)

TECHNICAL INFORMATION

- Application Examples
- List of Indexing Plunger Types (see page A42)
- Load Rating Information (see page 738)
- Metric ISO Fine Thread DIN 13 (see page A19)
- ISO-Fundamental Tolerances (see page A21)
- Stainless Steel Characteristics (see page A26)

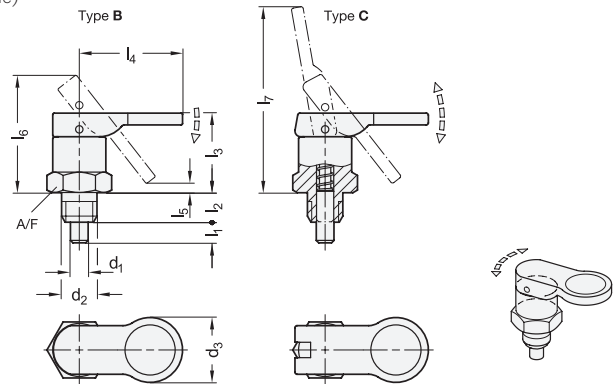

GN 823-ST-B

Description	d1 Plunger h9 Bore +0.08/+0.03	l1	d2	d3	l2	l3	l4	l5 ≈	l6 ≈	A/F	⚖
GN 823-4-5-B-R-ST-SW	4	5	M10	17	8	20	26	2	30	15	26
GN 823-4-5-B-F-ST-SW	4	5	M10 x 1	17	8	20	26	2	30	15	26
GN 823-5-5-B-R-ST-SW	5	5	M10	17	8	20	26	2	30	15	26
GN 823-5-5-B-F-ST-SW	5	5	M10 x 1	17	8	20	26	2	30	15	26
GN 823-6-7-B-R-ST-SW	6	7	M12	22	10	27	35	3	40	19	53
GN 823-6-7-B-F-ST-SW	6	7	M12 x 1.5	22	10	27	35	3	40	19	53
GN 823-7-7-B-R-ST-SW	7	7	M12	22	10	27	35	3	40	19	54
GN 823-7-7-B-F-ST-SW	7	7	M12 x 1.5	22	10	27	35	3	40	19	54
GN 823-8-10-B-R-ST-SW	8	10	M16	26	12	33	43	3	51	22	96
GN 823-8-10-B-F-ST-SW	8	10	M16 x 1.5	26	12	33	43	3	51	22	96
GN 823-10-10-B-R-ST-SW	10	10	M16	26	12	33	43	3	51	22	97
GN 823-10-10-B-F-ST-SW	10	10	M16 x 1.5	26	12	33	43	3	51	22	97



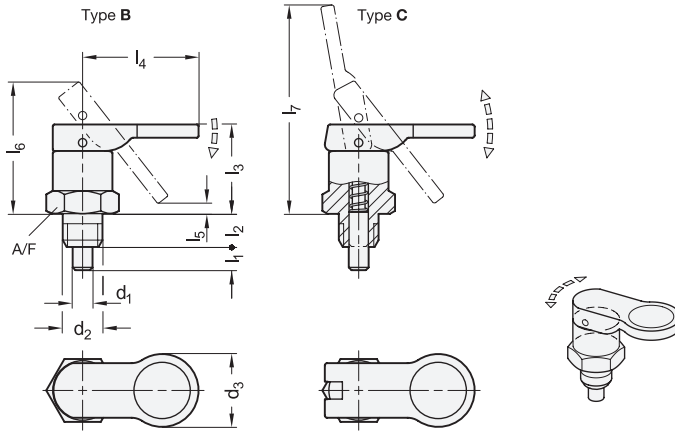

GN 823-ST-C

Description	d1 Plunger h9 Bore +0.08/+0.03	l1	d2	d3	l2	l3	l4	l5 ≈	l6 ≈	l7 ≈	A/F	⚖
GN 823-4-5-C-R-ST-SW	4	5	M 10	17	8	20	26	2	30	47	15	26
GN 823-4-5-C-F-ST-SW	4	5	M 10 x 1	17	8	20	26	2	30	47	15	26
GN 823-5-5-C-R-ST-SW	5	5	M 10	17	8	20	26	2	30	47	15	26
GN 823-5-5-C-F-ST-SW	5	5	M 10 x 1	17	8	20	26	2	30	47	15	26
GN 823-6-7-C-R-ST-SW	6	7	M 12	22	10	27	35	3	40	63	19	53
GN 823-6-7-C-F-ST-SW	6	7	M 12 x 1.5	22	10	27	35	3	40	63	19	53
GN 823-7-7-C-R-ST-SW	7	7	M 12	22	10	27	35	3	40	63	19	54
GN 823-7-7-C-F-ST-SW	7	7	M 12 x 1.5	22	10	27	35	3	40	63	19	54
GN 823-8-10-C-R-ST-SW	8	10	M 16	26	12	33	43	3	51	78	22	96
GN 823-8-10-C-F-ST-SW	8	10	M 16 x 1.5	26	12	33	43	3	51	78	22	96
GN 823-10-10-C-R-ST-SW	10	10	M 16	26	12	33	43	3	51	78	22	98
GN 823-10-10-C-F-ST-SW	10	10	M 16 x 1.5	26	12	33	43	3	51	78	22	98

GN 823-NI-B

STAINLESS STEEL

Description	d1 Plunger h9 Bore +0.08/+0.03	l1	d2	d3	l2	l3	l4	l5 ≈	l6 ≈	A/F	⚖
GN 823-4-5-B-R-NI-SW	4	5	M 10	17	8	20	26	2	30	15	27
GN 823-4-5-B-F-NI-SW	4	5	M 10 x 1	17	8	20	26	2	30	15	27
GN 823-5-5-B-R-NI-SW	5	5	M 10	17	8	20	26	2	30	15	27
GN 823-5-5-B-F-NI-SW	5	5	M 10 x 1	17	8	20	26	2	30	15	27
GN 823-6-7-B-R-NI-SW	6	7	M 12	22	10	27	35	3	40	19	54
GN 823-6-7-B-F-NI-SW	6	7	M 12 x 1.5	22	10	27	35	3	40	19	54
GN 823-7-7-B-R-NI-SW	7	7	M 12	22	10	27	35	3	40	19	55
GN 823-7-7-B-F-NI-SW	7	7	M 12 x 1.5	22	10	27	35	3	40	19	55
GN 823-8-10-B-R-NI-SW	8	10	M 16	26	12	33	43	3	51	22	96
GN 823-8-10-B-F-NI-SW	8	10	M 16 x 1.5	26	12	33	43	3	51	22	96
GN 823-10-10-B-R-NI-SW	10	10	M 16	26	12	33	43	3	51	22	98
GN 823-10-10-B-F-NI-SW	10	10	M 16 x 1.5	26	12	33	43	3	51	22	98

GN 823-NI-C

STAINLESS STEEL

Description	d1 Plunger h9 Bore +0.08/+0.03	l1	d2	d3	l2	l3	l4	l5 ≈	l6 ≈	l7 ≈	A/F	⚖
GN 823-4-5-C-R-NI-SW	4	5	M 10	17	8	20	26	2	30	47	15	27
GN 823-4-5-C-F-NI-SW	4	5	M 10 x 1	17	8	20	26	2	30	47	15	27
GN 823-5-5-C-R-NI-SW	5	5	M 10	17	8	20	26	2	30	47	15	27
GN 823-5-5-C-F-NI-SW	5	5	M 10 x 1	17	8	20	26	2	30	47	15	27
GN 823-6-7-C-R-NI-SW	6	7	M 12	22	10	27	35	3	40	63	19	54
GN 823-6-7-C-F-NI-SW	6	7	M 12 x 1.5	22	10	27	35	3	40	63	19	54
GN 823-7-7-C-R-NI-SW	7	7	M 12	22	10	27	35	3	40	63	19	55
GN 823-7-7-C-F-NI-SW	7	7	M 12 x 1.5	22	10	27	35	3	40	63	19	55
GN 823-8-10-C-R-NI-SW	8	10	M 16	26	12	33	43	3	51	78	22	97
GN 823-8-10-C-F-NI-SW	8	10	M 16 x 1.5	26	12	33	43	3	51	78	22	97
GN 823-10-10-C-R-NI-SW	10	10	M 16	26	12	33	43	3	51	78	22	99
GN 823-10-10-C-F-NI-SW	10	10	M 16 x 1.5	26	12	33	43	3	51	78	22	99





Indexing elements 8

Application examples

